

FEATURES

- Solid bar-stock drilled design
- 3 different shank styles
- Flanged process connection

APPLICATIONS

- Air & flue gas
- Tanks & vessels
- Oil & Gas applications
- Corrosive environments
- Power & Steel industries
- HVAC, Air filters & utilities
- On-shore/Off-shore application

Tapered Shank



STANDARD SPECIFICATIONS

Shank form	: Tapered
Flange material	: AISI 316 SS
Well material	: AISI 316 SS
Instrument connection	: ½" NPT (F)
Bore diameter	: 7 mm
Lag extension	: 50 mm
Root diameter	: By order
Tip diameter	: By order
Immersion length	: By order
Step / Taper Length	: By order
Tip thickness	: 5 mm
Process connection	: Flange as per ANSI B16.5, EN 1092-1
Flange facing type	: Raised face

DIMENSIONAL DRAWING

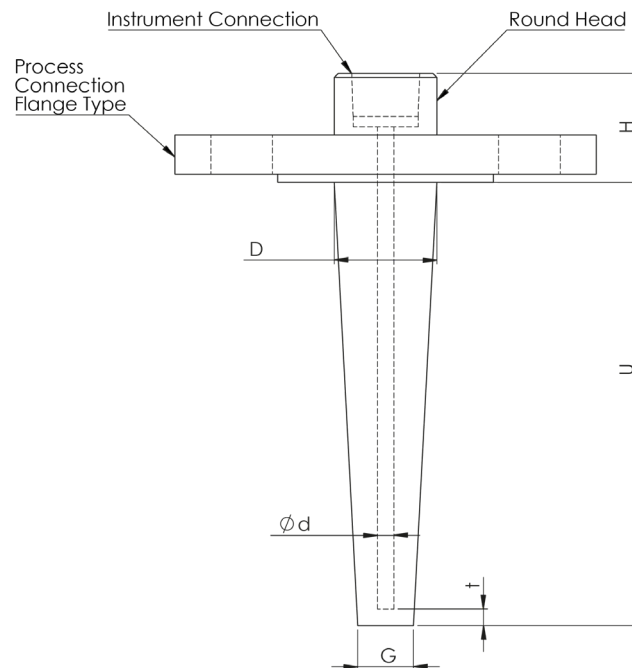

ORDERING CODES

1. SHANK FORM

T	Tapered	T
---	---------	---

2. FLANGE MATERIAL

MB	Carbon Steel / ASTM A105	MG	AISI 316L SS	MB
MC	AISI 304 SS	MV	Titanium	
MF	AISI 316 SS			
MM	Monel			
MO	Hastelloy C-276			
MR	Inconel 625			
MI	AISI 321 SS			

3. WELL MATERIAL

MB	Carbon Steel / ASTM A105	MG	AISI 316L SS	MB
MC	AISI 304SS	MV	Titanium	
MF	AISI 316 SS			
MM	Monel			
MO	Hastelloy C-276			
MR	Inconel 625			
MI	AISI 321 SS			

4. INSTRUMENT CONNECTION

02N	1/4" NPT (F)	04N	1/2" NPT (F)	02N
05N	3/4" NPT (F)	02B	1/4" BSP (F)	
04B	1/2" BSP (F)	05B	3/4" BSP (F)	
04M	M20 x 1.5 mm (F)			

5. PROCESS CONNECTION

XXX	Refer Flange Table for the codes	XXX
-----	----------------------------------	-----

6. FLANGE FACING

F	Flat Face	F
J	Ring-Type Joint	
R	Raised Face	

7. HEAD SIZE

XX	Mention in 'mm'	30
----	-----------------	----

Recommended :

30 mm for flanges up to 1.5" sizes

35 mm for flanges above 1.5" sizes

8. LAG EXTENSION ("T")

XXX	35 mm up to 250 mm	50
-----	--------------------	----

9. ROOT DIAMETER ("D")

XX.X	Mention in 'mm'	25
------	-----------------	----

10. TIP DIAMETER ("G")

XX.X	Mention in 'mm'	18
------	-----------------	----

11. BORE DIAMETER ("d")

N	6.35 mm (1/4")	C	9.0 mm
B	7.0 mm	O	10 mm
D	9.6 mm	G	13 mm
F	11 mm		

12. IMMERSION LENGTH ("U")

XXXX	50 mm up to 1000 mm	150
------	---------------------	-----

13. STEP STYLE

T	Tapered	T
---	---------	---

14. TIP THICKNESS ("t")

M	5 mm	M
N	6.35 mm (1/4")	
P	8 mm	
O	10 mm	

15. CONSTRUCTION

FA	Flange & well full penetration welded	FA
FB	Flange & well thread jointed and seal Welded	
FC	Flange & well seal welded	

16. COATING ON WELL & FLANGE

PD	PTFE	PD
----	------	----

NOTES

1. Other diameters, connections are available, please contact factory for details.

2. Please refer "Technical Reference" for the proper selection of connections according to Head size and Outer diameter of the well.

ORDERING CODES

17. OTHER OPTIONS

XI	Plug & chain in SS	
XK	Electro polishing	
XL	Marking by laser	
XM	Marking by engraving	XM
XN	Collar type (According to WFC)	

18. CERTIFICATIONS

TC	Material test certificate	TC
TD	Dye penetration test	
TF	PMI test	
TH	Hydro test certificate	
TN	NACE standards	
TW	WFC as per PTC 19.3TW:2010	

Ordering Example : W101-T-MB-MB-02N-XXX-F-30-50-25-18-B-150-T-M-FA-PD-XM-TC

Flange Table

ANSI B 16.5

Code	Size	Rating	Code	Size	Rating	Code	Size	Rating
A01	½"	150#	A02	½"	300#	A03	½"	600#
A04	½"	900#	A05	½"	1500#	A06	½"	2500#
A07	¾"	150#	A08	¾"	300#	A09	¾"	600#
A10	¾"	900#	A11	¾"	1500#	A12	¾"	2500#
A13	1"	150#	A14	1"	300#	A15	1"	600#
A16	1"	900#	A17	1"	1500#	A18	1"	2500#
A19	1¼"	150#	A20	1¼"	300#	A21	1¼"	600#
A22	1¼"	900#	A23	1¼"	1500#	A24	1¼"	2500#
A25A	1½"	150#	A26	1½"	300#	A27	1½"	600#
A28	1½"	900#	A29	1½"	1500#	A30	1½"	2500#
A31	2"	150#	A32	2"	300#	A33	2"	600#
A34	2"	900#	A35	2"	1500#	A36	2"	2500#
A37	2½"	150#	A38	2½"	300#	A39	2½"	600#
A40	2½"	900#	A41	2½"	1500#	A42	2½"	2500#
A43	3"	150#	A44	3"	300#	A45	3"	600#
A46	3"	900#	A47	3"	1500#	A48	3"	2500#
A49	4"	150#	A50	4"	300#	A51	4"	600#
A52	4"	900#	A53	4"	1500#	A54	4"	2500#

NOTES

1. Other diameters, connections are available, please contact factory for details.
2. Please refer "Technical Reference" for the proper selection of connections according to Head size and Outer diameter of the well.

03/03