

FEATURES

- All SS construction
- Adjustable needle design

APPLICATIONS

- Reduces dampening effect of process media

Adjustable Needle**STANDARD SPECIFICATIONS**

Type	: Adjustable needle
Material	: AISI 316 SS
Instrument connection	: 1/2" NPT (M)
Process connection	: 1/2" NPT (M)
Gaskets / Seals	: Viton
Maximum working pressure	: 400 bar
Maximum working temperature	: 180°C
Weight	: ~183 g

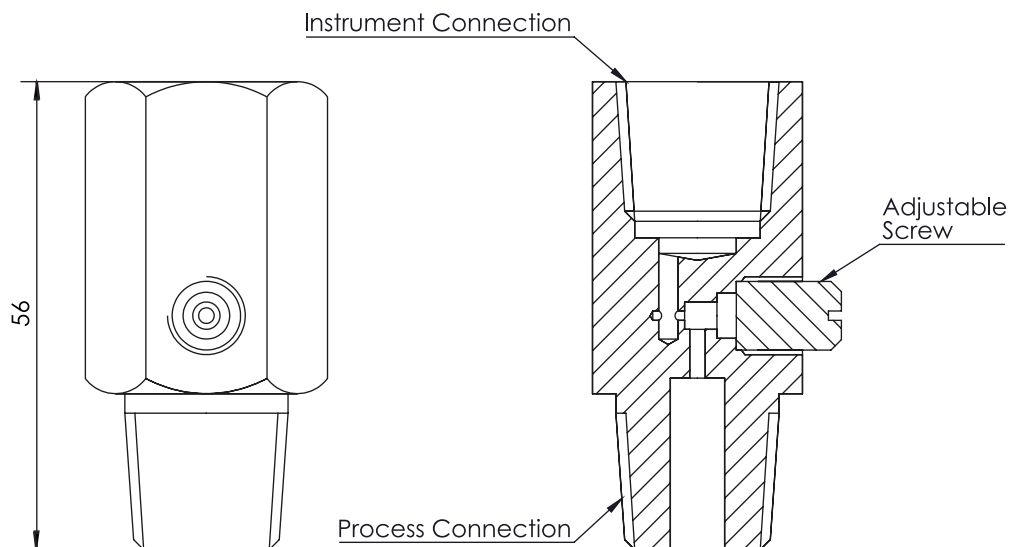
DIMENSIONAL DRAWING

All dimensions are in mm.

ORDERING CODES**1. TYPE**

AD	Adjustable needle	AD
-----------	-------------------	-----------

2. MATERIAL

MC	AISI 304 SS	
MF	AISI 316 SS	MF
MG	AISI 316L SS	
MM	Monel	
MO	Hastelloy C-276	

3. INSTRUMENT CONNECTION

02B	1/4" BSP (F)	
03B	3/8" BSP (F)	
04B	1/2" BSP (F)	
02N	1/4" NPT (F)	
03N	3/8" NPT (F)	
04N	1/2" NPT (F)	04N
04M	M20x1.5 mm (F)	

4. PROCESS CONNECTION

12B	1/4" BSP (M)	
13B	3/8" BSP (M)	
14B	1/2" BSP (M)	
12N	1/4" NPT (M)	
13N	3/8" NPT (M)	
14N	1/2" NPT (M)	14N
14M	M20x1.5 mm (M)	

5. OTHER OPTIONS

TC	Material test certificate	
TN	NACE standards	
TO	Use for Oxygen service	
XL	Marking by laser	XL

Ordering Example : AC45-AD-MF-04N-14N-XL

NOTE: Other process connections are available through adaptors.