

elbow fittings

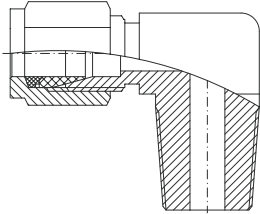

CME male elbow

available for tube $1/8$ " to 1" imperial and 4 mm to 25 mm metric, connections from $1/8$ " to 1" npt / bsp / bspt, standard material AISI316, fittings properly packed with the exposed threads protected.

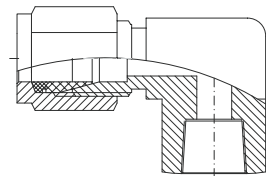

CFE female elbow

available for tube $1/8$ " to 1" imperial and 4 mm to 25 mm metric, connections from $1/8$ " to 1" npt / bsp / bspt, standard material AISI316, fittings properly packed with the exposed threads protected.

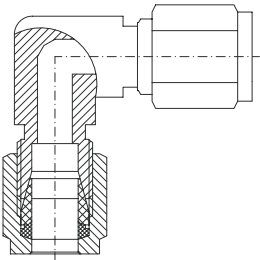

CUE union elbow

available for tube $1/8$ " to 1" imperial and 4 mm to 25 mm metric, standard material AISI316, fittings properly packed with the exposed threads protected.

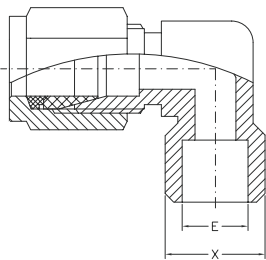

CSE socket weld elbow

available for tube $1/8$ " to 1" imperial and 4 mm to 25 mm metric, standard material AISI316, fittings properly packed with the exposed threads protected.

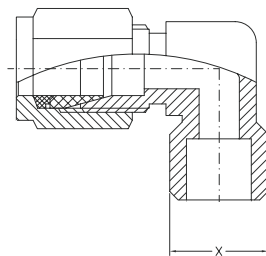

CBE but weld elbow

available for tube $1/8$ " to 1" imperial and 4 mm to 25 mm metric, standard material AISI316, fittings properly packed with the exposed threads protected.